

## SPECIFICATIONS

BATTERY MODEL	TERMINAL OPTIONS	CASE MATERIAL OPTIONS
NP18-12	Bolt fastened terminal, M5 lug	UL 94 V-0 UL 94 HB
Nominal voltage (V)		12
20-hr rate Capacity to 10.5V at 25°C (77°F) (Ah)		17.2
10-hr rate Capacity to 10.5V at 25°C (77°F) (Ah)		16.3
<b>TORQUE</b>		2-3Nm (17.7-26.6 in-lb)
<b>DIMENSIONS</b>		
Length		181mm (7.13 in.)
Width		76mm (3.0 in.)
Height over terminals		167mm (6.57 in.)
Weight		6.0kg (13.23 lb.)
<b>OPERATING TEMPERATURE RANGE</b>		
Storage (in fully charged condition)		-20°C to +60°C (-4°F to +140°F)
Charge		-15°C to +50°C (5°F to +122°F)
Discharge		-20°C to +60°C (-4°F to +140°C)
<b>STORAGE</b>		
Capacity loss per month at 25°C (77°F) (% approx.)		3
<b>CHARGE VOLTAGE</b>		
Float charge voltage at 25°C (77°F) (V)/Battery		13.65 (±1%)
Float charge voltage at 25°C (77°F) (V)/Cell		2.275 (±1%)
Float charge voltage temperature correction factor from standard 25°C (77°F) (mV)		-3
Cyclic (or Boost) charge voltage at 25°C (77°F) (V)/Battery		14.5 (±3%)
Cyclic (or Boost) charge voltage at 25°C (77°F) (V)/Cell		2.42 (±3%)
Cyclic charge voltage temperature correction factor from standard 25°C (77°F) (mV)		-4
<b>CHARGE CURRENT</b>		
Maximum charge current (A)		4.3
<b>DISCHARGE CURRENT</b>		
Maximum continuous discharge current, 5 sec. (A)		258
Short circuit current (A)		525
<b>IMPEDANCE</b>		
Measured at 1 kHz (mΩ)		10.4
<b>DESIGN LIFE</b>		
Yuasa design life at 25°C (77°F)		up to 5 yrs



### TERMINALS

#### Bolt fastened terminal, M5 lug

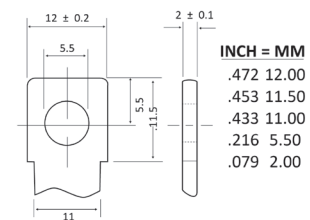

### LAYOUT

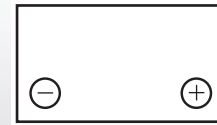

### 3RD PARTY CERTIFICATION

ISO 9001 Certificate  
 ISO 14001 Certificate  
 TAA Compliant – Made in Taiwan  
 DRC Conflict Free

### LONG SHELF LIFE

The extremely low self discharge rate allows the battery to be stored for extended periods up to one year at normal ambient temperatures with no permanent loss of capacity.

### FLOAT SERVICE LIFE

The expected service life is five years in float standby applications.



## DISCHARGE CHARACTERISTICS

Discharge Characteristics Curves at 25°C

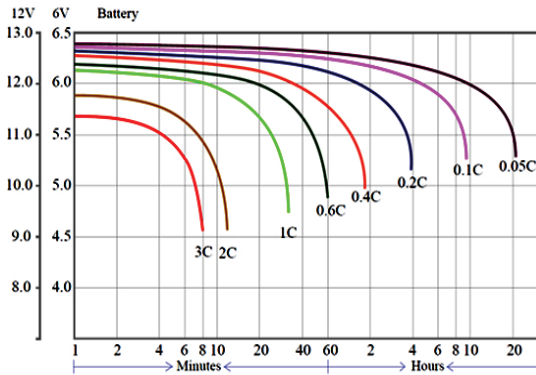

## FLOAT SERVICE LIFE

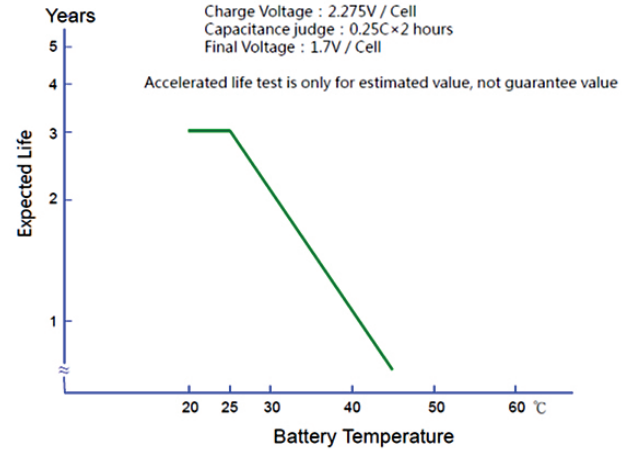

## CHARGE CHARACTERISTICS

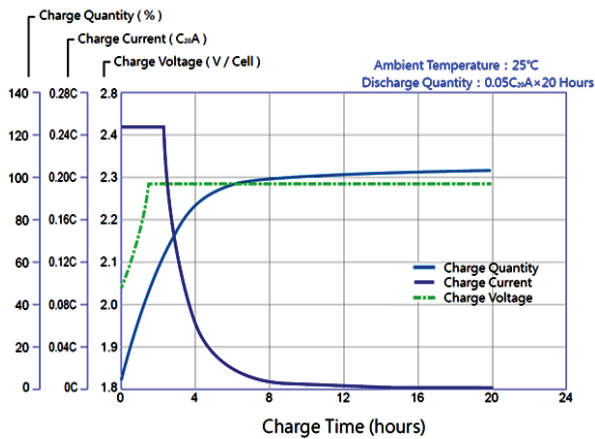

## CHARGE VOLTAGE

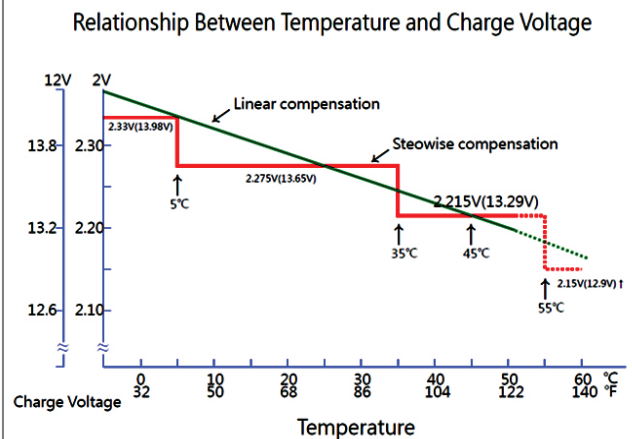

**WARNING:** Cancer and Reproductive Harm. Wash hands after handling. [www.P65Warnings.ca.gov](http://www.P65Warnings.ca.gov)

### ABOUT GS YUASA ENERGY SOLUTIONS, INC.

GS Yuasa Energy Solutions, Inc. is an American subsidiary of GS Yuasa Corporation, the world's second largest battery company and a 100+ year old Japanese corporation. GS Yuasa Energy Solutions (GYES) was formed in 2019 to address the growing energy storage and reserve power markets. GYES brings together and leverages GS Yuasa Group's advanced technologies with proven American market successes in lithium, telecom, UPS, alarm & security, and energy storage into a single business unit.

